

3D활용실습	
학 번	2501110032
성 명	이진우
감독	(서명)

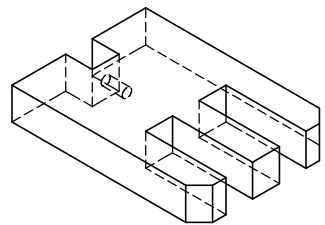
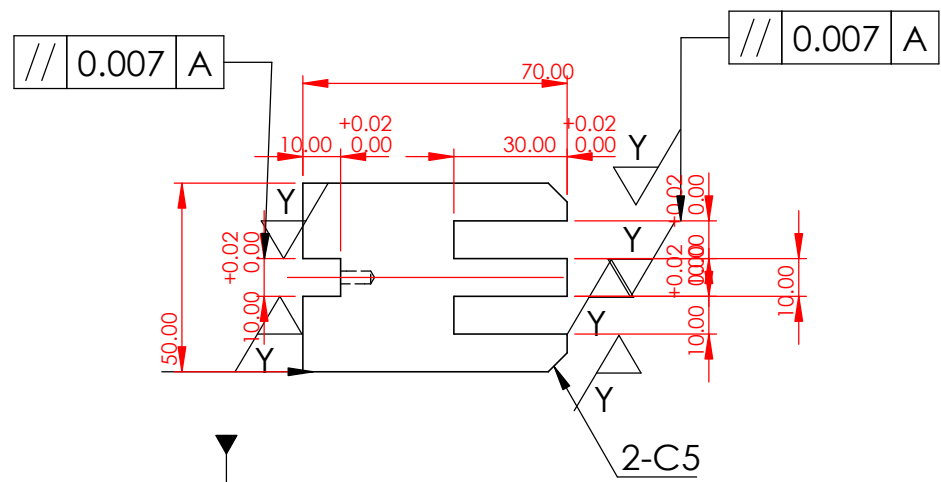
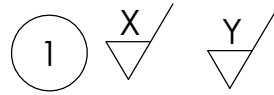

A

A

A

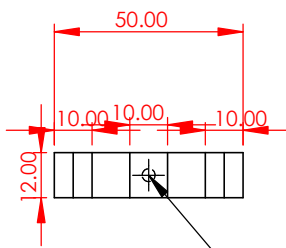
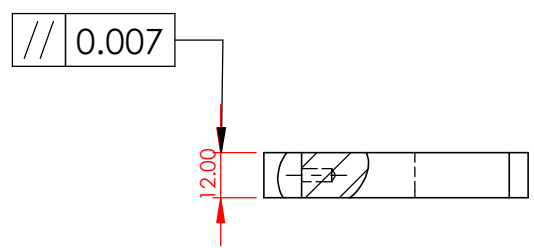

- 주서
1. 일반공차 - 가)가공부: KS B ISO 2768-m
나)주조부: KS B 0250 - CT11
 - 2.도시되고 지시없는 모떼기는 1x45 필렛과 라운드는 R3
 - 3.일반 모떼기는 0.2x45
 - 4.표면 거칠기 $\nabla = 6.3$ $\nabla = 1.6$

과제명	기말고사	척도	1:1
		각 법	제3각법