

### SD CARD PIN DESIGN

Pin No.	Name	Description
1#	CD/DAT3	Card detect/Data I/O
2#	CMD	Command
3#	VSS1	Ground
4#	VDD	Power
5#	CLK	Clock
6#	VSS2	Ground
7#	DAT0	Data I/O
8#	DAT1	Data I/O
9#	DAT2	Data I/O

#### NOTES:

##### 1.MATERIAL

HOUSING: HIGH TEMPERATURE THERMOPLASTIC.  
 CONTACT: COPPER ALLOY.  
 SHELL: COPPER ALLOY.

##### 2.PLATING

CONTACT AREA: GOLD FLASH PLATED OVER Ni.  
 SOLDER TAIL: 100 μ" MIN Sn/Pb PLATED OVER Ni.  
 SHELL SOLDER AREA: GOLD PLATED OVER Ni.

##### 3.RATING

CURRENT RATING: 0.5A  
 VOLTAGE RATING: 250VRMS  
 OPERATING TEMPERATURE:-25°C~90°C

##### 4.SPECIFICATION

CONTACT RESISTANCE: 40 MillioHMS  
 DIELECTRIC WITHSTANDING VOLTAGE: 500VAC MegOHMS  
 INSULATION RESISTANCE: 100 MegOHMS  
 INSERTION FORCE: 40N MAX.  
 SEPARATION FORCE: 2N MIN.

##### 5.UNSPECIFIED TOLERANCE: .XXX ±0.10

.XX ±0.25  
 .X ±0.38

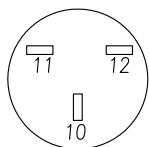
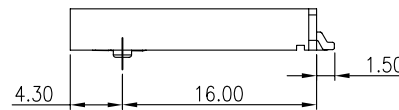
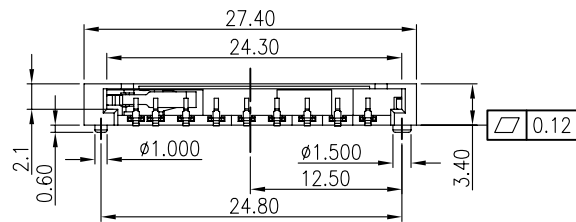

WITHOUT CARD

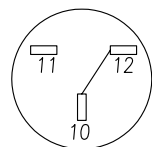

CARD INSERTED  
WRITE PROTCT:LOCK

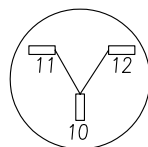

CARD INSERTED  
WRITE PROTECT:UNLOCK

10--WRITE PROTECT PIN  
 11--COMMON PIN  
 12--CARD DETECT PIN

<h1>X MULTIPLE</h1>		CONNECTING THE INFORMATION AGE	
XMULTIPLE ASIA 4F, No. 347, Yang Guang St., Neihu Chiu, Taipei, Taiwan 11475		XMULTIPLE USA 543 Country Club Drive #B 128 Simi Valley, CA 93065	
THIS DRAWING IS A CONTROLLED DOCUMENT.		CUSTOMER/NO:	
TITLE: SECURE DIGITAL MEMORY CARD CONNECTOR, NORMAL TYPE(SHORT)		DWG NO: XSDC-5-09M1-K000-00	
PART NO: XSDC-5-09M1-K000-00		DRAWN: ANNIE	
DIMENSIONS mm[inch]		SHEET 1 of 1	
REV 01		CHKD: JEFF	
		DATE: 09/11/04	